

Lancaster County Barns

10' x 10' Grid Tie Only System

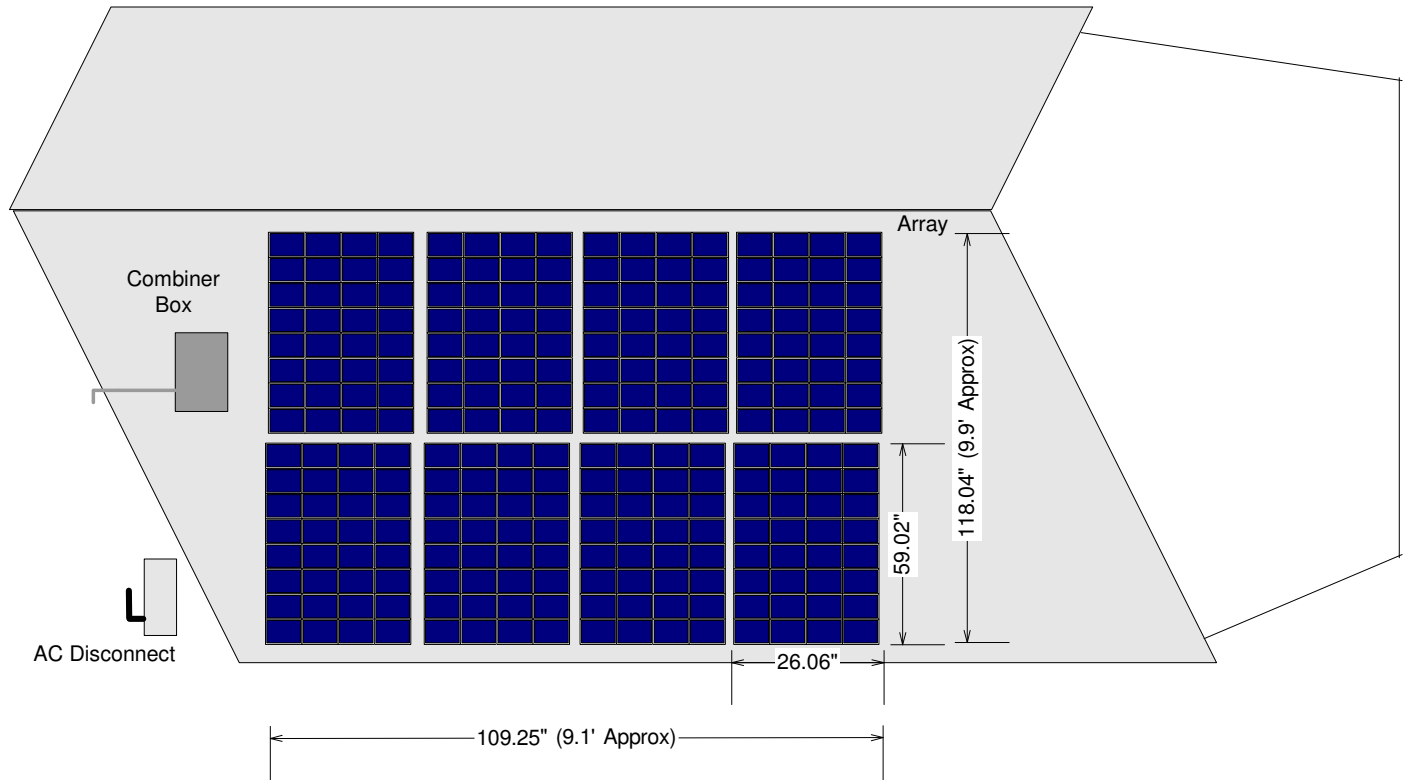
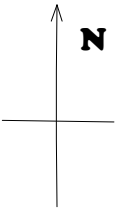

This system will produce about **1040 Watts** per hour. The customer will be able to offset their usage by this amount for each good sun hour they can capture. All componentry will be UL Listed and installed according to NEC Code. This system will terminate at an outside disconnect that will be accessible to a qualified electrician to make wire runs from there to the service box within the home. AC Connection will be at 240 VAC (Split Phase).